

MB-ES1.1  
MB-ES1.0

MB-ES1.1  
MB-ES1.0

HES FIELD CAMP SAN ANTONIO  
ELECTRICAL  
SITE PLAN  
SAN ANTONIO, TEXAS 78112  
MAINTENANCE BUILDING

MEAL SERVICE SERVICES  
1015 BROS. O'NEAL BLVD. DALLAS, TEXAS 75241-0114  
(952) 251-1346

**MULTATECH**  
ARCHITECTS - ENGINEERS  
FORT WORTH, TEXAS 76107

TYPE REG # F351  
2821 WEST 7TH STREET  
SUITE 400

PRELIMINARY:  
NOT FOR  
REGULATORY  
APPROVAL,  
PERMITTING, OR  
CONSTRUCTION

CHG. DESCRIPTION DATE BY

THE INFORMATION CONTAINED HEREON SHALL BE CONSIDERED THE SOLE PROPERTY OF HALLIBURTON COMPANY AND THE RECIPIENT THEREOF. INFORMATION TO PARTIES OUTSIDE THE RECIPIENT'S ORGANIZATION AND NOT TO BE DISCLOSED OR REPRODUCED WITHOUT THE WRITTEN PERMISSION OF HALLIBURTON REAL ESTATE SERVICES.

REVISION	
ISSUED	
APPROVED	
DATE	
ISSUE DATE	10/14/2011

MB-ES1.0  
SHEET 04 OF

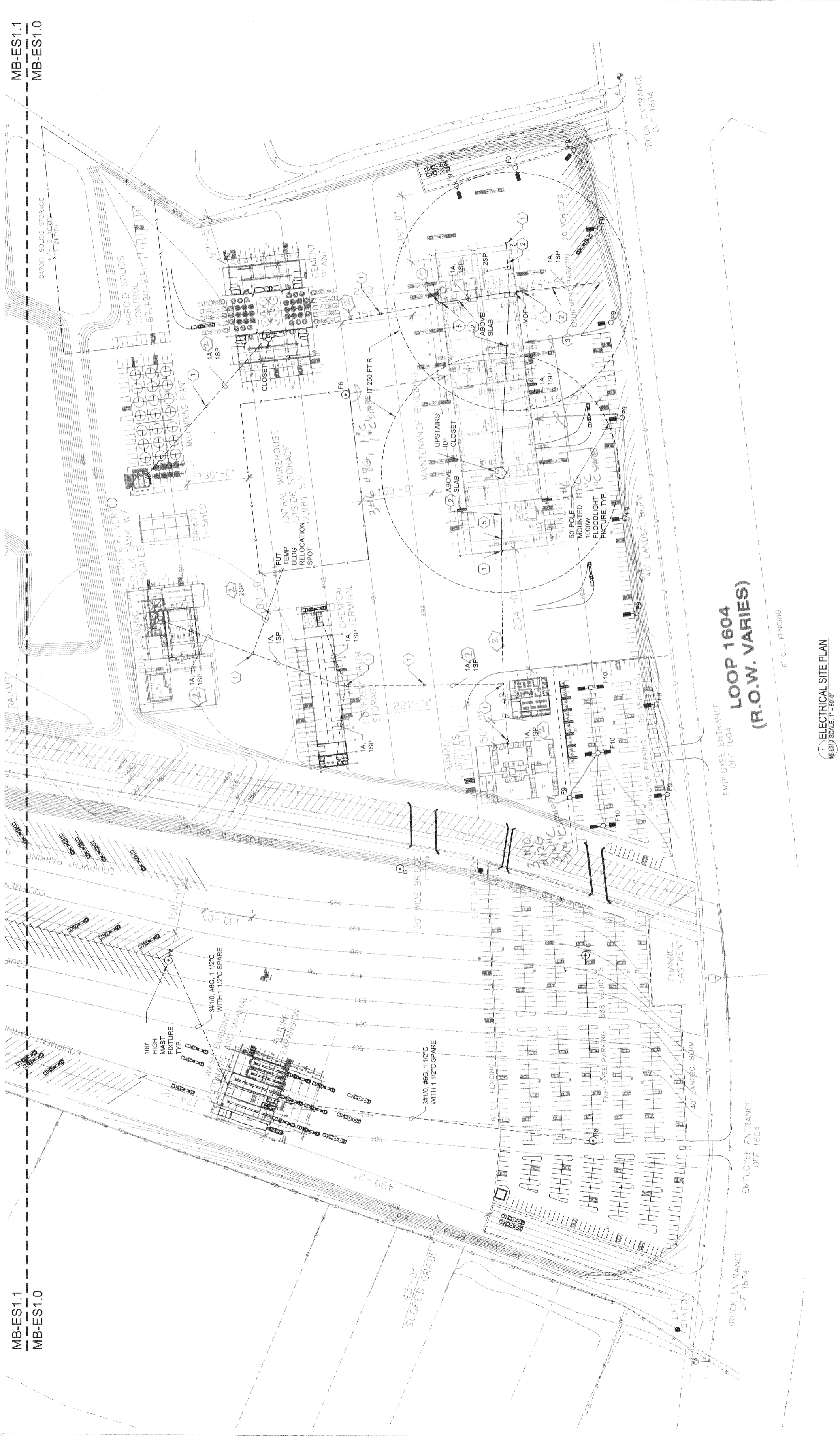

- KEY NOTES:**
- 24" x 48" x 24" D PULL BOX WITH TRAFFIC RATED LID (20HTO) MARK "COMMUNICATION"
  - (3/4)" SCHEDULE 40 PVC CONDUITS, QUANTITY ACTIVE & SPARE AS MARKED, 3/8" DEER UNLESS NOTED OTHERWISE. USE LONG RADIUS SWEEPS AT BENDS. PROVIDE 3 1/4" INNER DUCTS PER EACH 4" CONDUIT. COORDINATE POINT OF CONNECTION TO VOIP SERVICE PROVIDER. ATT: CONTACT MICHAEL MICHALSKI, 713-567-1922 (OFFICE) 552-286-8271 (CELL).
  - INCLUDE 3 INNER DUCTS WITH PULL STRINGS
  - RUN CONDUITS DOWN ON INSIDE OF WALL, THROUGH SLAB, AND INTO GROUND.

**ELECTRICAL SITE PLAN**  
SCALE: 1" = 80'-0"

**LOOP 1604**  
**(R.O.W. VARIES)**